

AIU Aerial Photograph



JAPAN

Akita  
AIU

● Sapporo

● Osaka

● Nagoya

● TOKYO

## ACCESS

### Airplane

**TOKYO**  
Haneda Airport

1 hour

Akita Airport

10 min by Car

**AIU**

### Bullet Train Shinkansen

**TOKYO**  
JR Tokyo Station

4 hours

JR Akita Station

30 min by Car

**AIU**

Four Seasons on Campus



## Center for International Affairs AKITA INTERNATIONAL UNIVERSITY

Yuwa Akita-City, 010-1292 Japan

Tel: +81 18 886 5937

E-mail: [international@aiu.ac.jp](mailto:international@aiu.ac.jp)

<https://web.aiu.ac.jp/en/>

 @AIUExchange

 / Official YouTube Channel for AIU Exchange Program

*Pamphlet publication date : March 2023*

# IMMERSE YOURSELF IN JAPAN

STUDY ABROAD @  
AKITA INTERNATIONAL UNIVERSITY





You want to immerse yourself in Japanese culture both inside and outside the classroom.

You aim to improve your Japanese while also taking courses in English in your major.

You seek interaction and friendships with students from Japan and around the world.

You want to learn more about Japanese culture, history and society in small, interactive classes.

**200+\***  
Local Community Visits

**40+**  
Student Clubs

**100%**  
On-campus Residence  
Guaranteed for  
Exchange Students

**11** LEVELS  
of Japanese  
Language

**100%**  
English-taught  
Classes

**59%**  
International  
Faculty

**25%\***  
International  
Students from

**35\*\***  
Countries  
& Regions

**203**  
Partners in

**51**  
Countries  
& Regions

**841**  
Total Students

**15:1**  
Student-to-  
Faculty Ratio

**17**  
Average Students  
/ Class

\*Based on the pre-pandemic university environment.  
\*\*As of September 2022

You are looking for a unique adventure, with experiences and friendships that will stay with you for life.

As of April 2022

## AIU Features



**Top Global University Project Selectee** (Global Traction)  
Japanese Ministry of Education

Times Higher Education Japan Rankings 2022

**No.1**

**University for Engagement**  
(Quality of education)

**No.6**

**University for Environment**  
(International education environment)

Rankings of Universities Recommended by High School Career Guidance Teachers 2022  
Daigaku Tsushin (Education information communications)

**No.1**

**University for Internationalization**

**No.1**

**Best Small Universities**

**No.4**

**Best Teaching Quality**

## What To Expect

At the leading edge of higher education in Japan, AIU offers an English-only content curriculum for all students. Classes are small and interactive so you can build relationships with your professors and classmates – from Japan and around the world. Since almost all AIU students live on campus, you'll find unique chances to get involved, including club activities and student-led events. AIU – and Akita prefecture – is a peaceful environment to study and immerse yourself in Japanese culture. AIU students visit schools, participate in local festivals, and even work in rice fields. While urban Tokyo is only an hour flight away, by living in Akita, you can experience true, rural Japanese culture in a way that no city resident could.

Come and immerse yourself in Japanese Culture!



# Message from the President

Akita International University (AIU), is located in idyllic surroundings in the northeast of Japan. Its ground-breaking pedagogy has made the university a most attractive destination for scholars from all corners of the Japanese archipelago as well as from over 50 countries/territories world-wide.

In its brief 2 decades, the university has come to be recognized as a transformative learning environment among higher education institutions in Japan. All of its formal, credit courses are conducted in English. AIU’s curriculum is a special blend of strong foundations in language, culture and communication studies, profound discourse, reflection, and a commitment to humanism characteristic of a strong liberal arts education, with transdisciplinary specializations in Global Studies, Global Business and Global Connectivity. This is strengthened by a year’s study abroad being mandatory for AIU students to graduate from their undergraduate programs, whilst welcoming overseas students from over 200 partner universities abroad.

There are myriad opportunities to explore the deep cultural heritage of the region and its spectacular natural environment from AIU’s verdant residential campus, around which one will find a warm, welcoming local community. AIU’s faculty is truly international, with the majority coming from outside Japan, and its bilingual administrative staff are kind, friendly and supportive.

I welcome you all to this unique learning environment, symbolized by its stunning library, open 24 hours each day all year long. Join this community of scholars, where you can establish lasting friendships and prepare to shape your world as global leaders of the future.

## Contents

P2	AIU Features	P16	Global Business Program	P30	Themed Houses
P4	A Message from the President	P18	Global Studies Program	P31	On-campus Medical / Counseling Support
P6	Community Outreach Services	P20	Global Connectivity Program	P32	Semester / Year Program
P8	Clubs and Circles	P22	Sample Course List		Basic Information about Akita Prefecture
P10	All-English Curriculum	P24	Nakajima Library	P33	Degree Program / Akita Highlights
P12	Japanese Language Program	P26	Campus Life and Academic Support	P34	Worldwide Network
P14	Japan Studies Program	P28	Housing and Dining	P36	Access to AIU

# Monte CASSIM

Chair of the Board/President, Akita International University

1947	Born in Colombo, Democratic Socialist Republic of Sri Lanka
1970	B.Sc. Built Environment, Faculty of Natural Sciences, University of Sri Lanka, Colombo
1974-1981	Research Fellow and Coordinator, Group Asia 80 Program, Japan Center for Area Development Research
1976	M.Eng. (Urban Engineering), Graduate School of Engineering, The University of Tokyo
1976-1977	Lecturer and Secretary of the Committee for Graduate School Establishment, University Sains Malaysia
1977-1982	Doctoral Program (Urban Engineering), Graduate School of Engineering, The University of Tokyo (Withdrawal after completing course requirements to work full time in industry)
1980-1984	Architect at Design Management Division, Design Department, Mitsui Construction Ltd.
1985-1994	Senior Research Fellow (U.N. Expert) and Program Coordinator, United Nations Center for Regional Development
1994-2018	Professor, Ritsumeikan University
2004-2009	President, Ritsumeikan Asia Pacific University
2004-2012	Vice Chancellor, Ritsumeikan Trust
2013-2014	Special Aide to the Chancellor, Ritsumeikan Trust
2014-2017	Member, Board of Councilors, Ritsumeikan Trust
2014-2021	Executive Trustee, Akita International University
2015-2018	Assistant Trustee, Ritsumeikan Trust
2018-2021	President, Trustee and Professor, Shizenkan University
2021-present	President (Chair of the Board), Akita International University
Other prominent posts including University Council Executive Trustee of Vietnam-Japan University, Deputy Chairman of the Board of Councilors of Okinawa Institute of Science and Technology and Senior Advisor to the Prime Minister of Sri Lanka	

Publications include *Concepts of Sustainability* (Chapter 2 : *An introduction to sustainability science* (Horitsu Bunka Sha, 2013)). He has also given many lectures at the Sri Lanka Association for the Advancement of Science (SLAAS) and universities in Japan and abroad and more.

In 2016, he was awarded the Order of the Sacred Treasure [Gold Rays with Neck Ribbon] from the Government of Japan for his contribution to the promotion of private education in Japan and his continuous efforts to promote mutual understanding between Sri Lanka and Japan.

In 2017 he received a National Honours Lifetime Award (Vidya Nidhi) for Contributions to science and technology by the Government of Sri Lanka.



# Community Outreach



AIU's Research and Community Outreach Services (RCOS) arranges many kinds of activities with the local community. Consistently rated among students' favorite aspects of AIU, these activities offer a unique backstage pass to experience rural Japanese life and culture.

## SAMPLE ACTIVITIES

- Teaching English and cultural exchange activities at AIU and local schools
- School holiday parties including Halloween and Christmas with children
- Cooking local and international dishes with schools and local community groups
- Rice planting and harvesting with schools and farming communities
- Homestays and activities with local community
- Participating in set-up and execution of local festivals
- Testing and evaluating new local tourism programs



AIU Community Outreach Services  
[https://www.youtube.com/watch?v=5sMF5qou\\_RI](https://www.youtube.com/watch?v=5sMF5qou_RI)



## PROGRAM SPOTLIGHT



Kindergarten Cultural Exchange



Traditional Rice Planting



Glass Art with Local University



Elementary English Teaching



### STUDENT VOICE

#### Aida Nezir Pachedji

Leiden University, Netherlands

I am glad I participated in the activities organized by RCOS. I think more international students should be involved and interact with the local people through RCOS' unique opportunities to learn more about Japanese culture and what the educational system is. One of the most touching and positive experiences was when I went to an elementary school and played a game with the school kids. The school kids were very curious, easy to talk to and eager to learn new things. I felt so energized and was filled with positive emotions after the experience. I hope more students get involved and get out of their comfort zone.



### STUDENT VOICE

#### Chia Chun Chien

National Taiwan University, Taiwan

RCOS activities were definitely the best part of my stay in AIU. Of all the 3 activities I've attended, I enjoyed the Nakasen elementary school visit the most. The activity was to be an assistant in their English class and the topic assigned was to introduce my elementary school memories. It was amazing for both me and the kids to share the difference between countries and experience different cultures by face-to-face interactions. Although English was the only required ability, if you have a basic fluency in Japanese, you can enjoy RCOS activities even more. In the class, I spoke in a mixed language of Japanese and English to help the kids understand better and it also greatly improved my Japanese. If you ever have a chance to be part of the AIU family, do not miss these wonderful opportunities!



# Clubs and Circles



Join one of AIU's 40+ clubs and circles to pursue your passions, build friendships, and practice intercultural communication in several languages. AY2022 clubs are listed below, but all students are also welcome to propose new ideas.

## Japanese Culture

- Japanese Calligraphy
- Japanese Dance
- Kanto Team
- Kendo
- Kimono
- Kyudo / Japanese Archery
- Tea Ceremony
- Wotagei / Dance performance swings two glow stick in both hands
- Yatose Team / Japanese Contemporary Dance

## Arts, Culture, and Music

- A Cappella
- Board Game
- Dance
- Hawaiian Hula Dance
- Jazz Circle
- Language Expression Club
- Musical Theatre
- Rock Band

## Common Interests

- AIU Revival and Reconstruction Supporter
- AIU Student Ambassadors
- Akita Study Abroad Promoters
- AUWA / Local Community Interaction
- Bible Study
- Debating Society
- Diversity Club
- Environmental Club
- FROMPROJECT Akita / Contribute to Solving Local Issues
- Happy People in Akita / Local Travel
- Model United Nations Club
- Northeast Asia Student Round Table
- Programming Club
- Red Cross Youth Volunteer Corps
- Sign Language
- Speech Club
- V-ACT / Volunteer Group

## Sports

- Badminton
- Baseball
- Basketball
- Flying Disc
- Futsal / Men's
- Futsal / Women's
- Rugby
- Shorinji Kenpo / Shaolin Boxing
- Soft Tennis
- Spikeball
- Table Tennis
- Tennis
- Volleyball
- Wandervogel

## Sports

### Volleyball Club



## Common Interests

### AUWA

#### Local Community Interaction

## STUDENT VOICE

### Nicol Juferova

Linköping University, Sweden



The reason I joined the volleyball club was because I wanted to try something I've never done before. This club, as the rest of the clubs at AIU, is both for those who are complete beginners and for those who want to get even better. This was fortunate for me, since I had never done neither a ball- nor a team sport before. Everyone is extremely patient and they don't mind teaching you what they know. It's a perfect way to have fun after studying all day and the friendships made will last for a lifetime!

## STUDENT VOICE

### Orsolya Fülöp

Comenius University, Slovakia



When I joined the AIU community in the last spring semester, I was overwhelmed by the possibilities AIU had to offer in terms of club activities. That is why I joined 4 of them in total. I joined 1 activity each semester in AUWA – rice planting and rice harvesting. It was a truly unique experience. While the hard work helped me disconnect from all the stress of everyday student life, I had the opportunity to learn more about the local culture first hand, for which I am grateful. Thank you AUWA!



# All-English Curriculum

## Small Classes, Mixed Japanese-International Classrooms

Gain exposure to global viewpoints in our small, diverse classrooms and acquire the credits you need from our wide range of course options.



### AIU ACADEMIC ADVANTAGE

#### International Exchange of Ideas in English

AIU brings together students from around the world in discussion-based small classes for a unique exchange of ideas and values. Each semester, approximately 25% of our student body is made up of international students, representing an average of 35 countries and regions. The combination of Japanese and international students in small classrooms gives students the opportunity to forge personal connections across cultural barriers and develop intercultural communication skills.

#### Japanese Language and Japan Studies

Our Japanese Language and Japan Studies programs are second to none. AIU offers 11 levels of core Japanese each semester, with a placement test offered during orientation, as well as skill and practice courses at the upper levels. Japan Studies includes everything from Akita Studies and traditional arts, to advanced courses in Japanese Business Culture or Japan-U.S. Relations. Turn the page for more!

#### Ease the Stress of Study Abroad

AIU is Japan's only university to offer all content courses in English, so international students can be sure to earn the credits they need toward their degrees. Our course offerings and syllabi are available online (see page 22 for examples) and our 4.0 GPA scale and 15-week semester facilitate compatibility with systems around the world. Our unique Academic Calendar (page 32) makes it easy to study at AIU for either the fall or spring semester, or a full year!



# Japanese Language PRG.



## UNPARALLELED LANGUAGE IMPROVEMENT

AIU offers 6-credit, core Japanese courses, so you can earn a total of 18 credits (36 ECTS) of core Japanese in a single year, including the Winter Program, plus take additional skill-specific courses, as well! Our small sizes, internationally experienced professors, and extracurricular activities will give you many opportunities to practice and improve your Japanese skills.



**Dr. Yuko Abe**  
Head, Japanese Language Program

We encourage all international students to enroll in one of our 11 levels of core Japanese courses, whether you are an absolute beginner in studying Japanese or have passed the JLPT N1. Taking classes in Japanese language and culture, in addition to living with Japanese students and participating in extracurricular activities, will help you to make your study abroad experience most valuable and beneficial. Our instructors have many years of experience in working with international students, both in Japan and abroad. The small size of our classes and a wealth of additional individual support systems provide all the resources you need to reach your language learning goals.

## Customize Your Studies

11 levels of core Japanese courses plus skill-specific courses allow you to meet your language goals. If you want to learn introductory Japanese, but cannot fit intensive classes into your schedule, AIU also offers JPL 100, a 3-credit, introductory course.

## Personal Support and Mentorship

In addition to our experienced professors, graduate students from AIU’s Japanese Language Teaching Practices Program and tutors from the Academic Achievement Center will eagerly work with you one-on-one. Take full advantage of AIU’s small-campus environment to forge the close personal relationships with Japanese students that will help you succeed.

## Course Offerings

Semester /Program	JPL Course Level	Pre-Elementary	Elementary	Upper Elementary		Intermediate				Higher Intermediate		Advanced	
		100 ★	110	210	220	310	320	330	340	410	420	460	470
Spring Semester	Core	★	○	○	○	○	○	○	○		○		○
	Skill					Pronunciation							
						Reading							
						Kanji					Writing		
				Speaking						Speaking			
										Chinese-Japanese Interpretation			
Fall Semester	Core	★	○	○	○	○	○	○		○		○	
	Skill					Pronunciation							
						Reading			English-Japanese Translation				
				Kanji				Writing					
				Speaking						Speaking			
										Japanese-Chinese Translation			
Winter Program	Core			○	○	○	○	○	○				
	Skill									Reading Current Topics			
											Japanese Language in Films		

\*JPL100 is a 3-credit introductory course. All other core courses are 6-credit courses.  
\*\*Please note that some levels may not be offered depending on the situation of the semester.



## STUDENT VOICE

**Usarat Sukudom**  
Mahidol University International College, Thailand

I studied “Intermediate Japanese I”. The outstanding points that I like about Japanese class are comprehension and practical skills. Each time we read the texts, we had a chance to understand aspects of Japanese culture such as Studio Ghibli, Mount Fuji, and Izakaya, and discuss them together with classmates as well as Japanese class visitors. In addition, I could try giving full Japanese presentations, sending emails, and even writing a letter to my home university sensei, too. Japanese class in AIU is not only about learning language but also cultivating your ability to be able to use Japanese as well.



# Japan Studies PRG.



## CONNECTING THE CLASSROOM AND REAL-WORLD EXPERIENCE

Get the most out of your time in Japan by immersing yourself in the local culture and participating in community outreach activities, traditional festivals, and AIU student clubs. AIU's Japan Studies courses are designed to provide both scholarly and experiential perspectives, which will deepen students' insight into the nature of Japanese culture, society, and sensibilities.



### Dr. Yoshitaka Kumagai

Director, Japan Studies Center

The Japan-related curricular and co-curricular offerings and opportunities at AIU are unique and second to none anywhere in Japan. Students can enjoy taking courses that range from local traditional performing arts, Japan's traditional arts of tea and flower arrangement, or contemporary Japanese business world, to the interplay of popular culture and Japanese society today. Combine serious study of the Japanese language, coursework in English about Japan, and direct access to the people, fields, and cultural traditions of Akita, Tohoku, and Japan at large for an unforgettable learning experience.



## Reaching Across Disciplinary Boundaries

The Japan Studies curriculum has expanded to include a wider range of locally-focused courses that invite careful consideration across multiple, academic disciplines. Current Japan-focused course offerings incorporate analysis from political, legal, international, economic, historical, anthropological, religious, cultural, and aesthetic viewpoints.



## From Traditional Arts to Popular Culture

AIU's Japan Studies course options enable students to perceive connections among current popular culture phenomena and the more traditional cultural roots from which these artifacts spring.

So, alongside coursework focused on anime and cinema, students may practice the traditional arts of tea ceremony and Ikebana (flower arrangement), as well as discover more about the philosophies behind these traditional aesthetic practices. AIU's traditional arts classes are held in a serene Japanese tatami mat room - the perfect place to quiet the mind and develop greater awareness of the Japanese spirit.

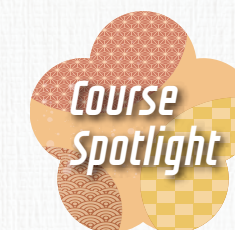

JAS 135

### Traditional Japanese Arts II: Ikebana, Kabuki, Noh, Buyo Dr. Kaeko Chiba

This course will guide you through the fascinating contemporary world of Japanese traditional arts, particularly Ikebana and flower culture in Japan. Through practicing Ikebana *jitsugi* (practice), investigating the *Iemoto* (grand master) system and studying styles of training in other art forms, you will gain valuable insight into the rich possibilities for the Japanese traditional arts in the future. This course is ideal for any students who are interested in Japanese traditional culture, and those who wish to start or continue studying the essence of Japanese society.

## STUDENT VOICE

### Joseph Falcon

Centre College, USA



My experience in Ikebana in the course of "Traditional Japanese Arts II: Ikebana, Kabuki, Noh, Buyo" had encouraged much reflection on the Japanese arts. It has allowed me to interact with nature in a much more intimate manner and analyze the historical and cultural significance of the Japanese traditional arts. From the religious syncretism between Shintoism and Buddhism, to modern contemporary Ikebana arrangements that test our preconceived notions, I've become heavily inspired to continue practicing Ikebana when I return home. I believe a global liberal arts education is an effective way to disperse the Japanese traditional arts and allow it to continue its legacy abroad.



# Global Business PRG.



## THEORY AND PRACTICE FOR DIVERSE APPLICATIONS

AIU's business program provides students a firm grounding in economic theory as well as a practical education in in-demand skills, such as marketing, leadership, and business data analysis. AIU offers students the opportunity to develop their business strategy skills in an interactive environment that will enable them to compete in today's market, respond to changes in the market, and lead, no matter what challenges the future may hold.



### Dr. Clinton Watkins

Director, Global Business Program

Our curriculum prepares students for meaningful careers after university, whether they join the workforce here in Japan or abroad, start their own business, or continue their studies at the graduate level. The Global Business Program offers introductory and advanced courses in business disciplines, including accounting, business culture, economics, finance, law, management, marketing, quantitative analysis, and sustainability. Our courses emphasise applying knowledge to solve the critical issues of today and tomorrow. We offer interactive classes that engage students in developing their technical, critical thinking, and communication skills, which will be essential for doing business in our rapidly evolving future.



## The Japanese Example and Regional Expertise

As Japan's longest-standing all-English undergraduate program, AIU offers the most comprehensive opportunity for international students to gain an inside perspective on the Japanese economy and business, with courses including Japanese Finance and Practices under Globalization, and Japanese Business Culture. Instructors across all courses introduce examples from Japanese media and current events to help students understand Japan's values in relation to its neighbors and trading partners around the world. Also, several instructors have substantial Japanese business experience.



## Networking and International Cooperation Practice

In business and economics courses at AIU, you will develop your ability to communicate ideas in an international environment and exchange experience and opinions with classmates from around the world. Through presentations, teamwork, and case studies in a small class environment - averaging 17 students - you will work directly with Japanese and international students from 203 partners in 51 countries and establish professional connections that will follow you home and into your business career.

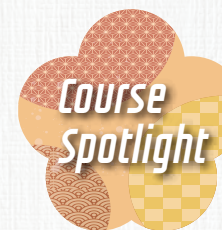

ECN 316

### Quantitative Methods for Marketing Dr. Wenti Du



How do businesses gather and use information to make effective marketing plans? This course provides students with knowledge of the practical statistical and quantitative techniques used to make efficient marketing decisions. Students design and conduct quantitative marketing research for real-world projects of their choice. They interpret the results of their quantitative research and learn how to make decisions that contribute to business success. The course is delivered as a combination of lectures and seminars.

## STUDENT VOICE

### Joaquin Villar

Universidad Adolfo Ibáñez, Chile



"Management Principles and Practices" is a course I would recommend to anyone who is interested in acquiring a broad basis of knowledge not just in the science of Management, but also on how all kinds of organizations work and behave. The great thing about this course is that it is structured around the experiences and perspectives of the students as we constantly use our own organizational backgrounds to apply the concepts learned in class. From school clubs to part-time jobs, any experience can be used for understanding the concepts in a comprehensive and interactive way!



# Global Studies PRG.



## COURSES AVAILABLE ACROSS DISCIPLINES

The Global Studies Program is composed of three Clusters (academic fields): Global Society, Political Science and International Relations, and Sustainability Studies. The Global Studies Program invites students to take courses in diverse fields from those Clusters. Students will accumulate and deepen their knowledge and refine their flexible thinking and analytical skills without being confined to conventional ideas and values through active participation in learning activities.



### Dr. Norihito Mizuno

Director, Global Studies Program

For students who are interested in studying about the world, a particular region, or a country, going abroad is an indispensable part of their academic experience, although it may seem daunting at first. With an all-English curriculum, small class sizes, and a balance of lecture and discussion courses, AIU offers a familiar environment to international students so that they will have the least trouble adjusting. Our strength is our active and diverse student body - many of our courses have at least 5-6 nationalities represented - that constantly provides each student with a welcoming environment.

### Global Society Cluster

Amid globalization, humanity faces diverse issues such as poverty, disparity, migration, discrimination, and human rights, as well as friction caused by differences in religion, ideology, and culture. Students will explore a wide range of issues spanning from issues in local communities to matters on a national, regional, and global scale.

### Political Science and International Relations Cluster

Courses in this cluster are diverse in multiple fields such as political science, geography, history, and international relations. Students will learn the laws and political systems of Japan and other nations in the world and international relations between two nations and multiple nations.

### Sustainability Studies Cluster

With globalization and advances in science and technology in this age, various environmental and resource-related issues are requiring urgent attention. As seen in the 17 Sustainable Development Goals, or SDGs, adopted by the United Nations in 2015, we must now take concrete action toward sustainable development. Students will study the major issues that humanity faces, such as the construction of a sustainable environment, economy, and community, and attempt to find an ideal society for humankind and the environment from multiple perspectives.

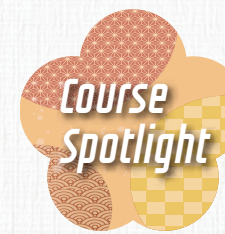

SUS 310

**Conservation and Sustainable Development**  
**Dr. Yoji Natori**



Conservation is at the heart of sustainable development. This course will cover the key aspects of conservation and demonstrate the roles of conservation in achieving sustainable development with real-world examples and case studies on wide range of views from the landscape and community perspectives (the satoyama approach) and the business consideration of natural environment (the natural capital concept). The course also covers the economic, social and policy frameworks in which these examples are embedded. Through the lectures, discussions and the group project, the course strives to drive home “If we cannot protect our only planet, nothing else matters.”



### STUDENT VOICE

#### Charlotte Mason

The Australian National University, Australia

I enrolled in the special lecture series “Special Topic 5: Eurasia Foundation Endowed Chair: Thinking about the Possibility of ‘Asian Community’ in Akita” in the fall semester and really loved it! It was so fulfilling to be able to hear from scholars about their research and learn straight from the source. The topics were all unique and interesting and I felt that I was able to take so much in. The scholars asked questions that really made me think. My favorite lecture was about identity in community, which took place towards the end of the course. I felt that this was a very unique topic that was very consequential to the theme of the course. I hope that I can take more courses like this because I got so much out of it.





# Global Connectivity PRG.



## DIALOGUE BETWEEN HUMANITY, CULTURE, COMMUNICATION, AND TECHNOLOGY

In our complex global society, where information spreads globally in an instant, we need to understand how digital technologies and innovations such as AI are changing us, and how we can live meaningful lives in a world that is in constant change. In the Global Connectivity Program, students explore both the humanities – culture, literature, and philosophy – which allows them to find meaning and values of our lives, and technologies, such as computation and AI, which are the foundation of our modern society. Students identify and explore connections between the humanities and technology and develop a holistic appreciation of their connectedness, allowing them to serve as effective bridges between these two domains in future society.



### Dr. Florent Domenach

Director, Global Connectivity Program

The Global Connectivity (GC) Program is a course of study that invites students to bridge the humanities and technology divide, focusing on digital technologies and AI, which are central to our lives. With diverse course offerings ranging from philosophy and art history to information science and cyberpsychology, students are encouraged to explore the transdisciplinary nature of an International Liberal Arts education. Through discussion and collaboration, students will deepen their critical thinking, develop literacy over both modern technology and humanities, and build an understanding of how human thinking and action are influenced.

## Humanity, Culture, and Communication Cluster

This cluster (academic fields) is a selection of humanities courses specifically designed to provide opportunities to acquire a broad scope of knowledge in areas such as history, culture, and art, and to develop language and analytical skills.

## Technology and Future Society Cluster

Courses in this cluster will allow you to learn the importance of controlling the digital environment, rather than being controlled by it. The Technology and Future Society cluster explores the impact of digital technologies on all aspects of our modern lives, including how they shape the way we work, communicate, access, and process information.



PSY 310

**Cyberpsychology**  
Dr. Pamela Taylor

Many users of internet technology find it indispensable, but also addictive in ways that traditional technology is not. This has led to curiosity about how cybertechnology can be so engrossing, as well as fears that it is altering how humans think. This class will investigate our interactions with cybertechnology, including how it harnesses innate features of our cognitive systems to create its compelling effects, and how it acts as a socio-cultural environment that influences how we think and act.



## STUDENT VOICE

### Minyoung Hong

Seoul National University, Korea

The Cyberpsychology course seemed to be the best way to figure out the reason why I am so immersed into the online world. Rather than a hard-working class with loads of assignments, every class was a time to learn psychological theories with ease and share experiences with each other throughout the semester. Where would I ever have the opportunity to talk about my personal experience in cyberspace with students from Japan, the U.S., Canada, and Spain? I chose this course regardless of my major, but I am still highly satisfied. I'd like to recommend this course to everyone, especially those who rely highly on social media and smartphones.

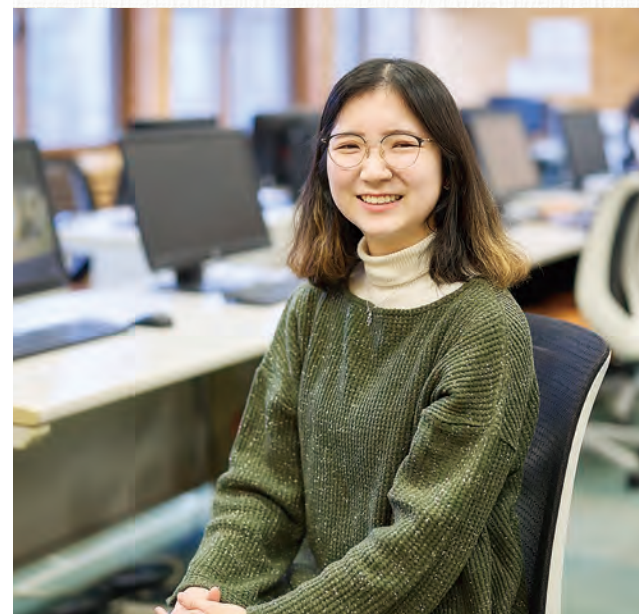



# Sample Course List

This is a partial list of courses offered in Academic Year 2023. Course availability is subject to change. For the most recent list, availability by semester, credit information, and specific requirements, please see <https://web.aiu.ac.jp/en/academic/>.  
Course Levels 1XX: Foundational / 2XX: Intermediate / 3XX: Advanced / 4XX: Capstone seminars and some Foreign Language courses

## Certificate of Concentration in Japanese Language and Culture Studies

International students can earn AIU's Certificate of Concentration in Japanese Language and Culture Studies by completing 15 credits of Japan Studies courses offered in English, including at least one course at the 300 level or higher, as well as 15 credits of Japanese language courses at or above the 310 level with a GPA of 2.50 or higher for the courses. Courses with  will be counted for the certificate.

## Japan Studies

- JAS** 115 Traditional Japanese Arts I: Tea Ceremony
- JAS** 135 Traditional Japanese Arts II: Ikebana, Kabuki, Noh, Buyo
- JAS** 200 Japanese Literature I: Modern Literature
- JAS** 201 Japanese History I: Premodern Japan
- JAS** 202 Japanese History II: Modern Japan
- JAS** 220 Japanese Politics
- JAS** 225 Japan's Constitution and Law
- JAS** 250 Introduction to Japanese Society
- JAS** 280 Akita Studies I: Introduction to Akita
- ANT** 300 Personhood and the Self: Anthropological Perspectives
- ART** 300 Japanese Art History in Global Context
- JAS** 300 Japanese Literature II: Postwar Identity in Literature
- JAS** 305 Religions in Japan
- JAS** 310 Intercultural Perspectives on Japanese Society
- JAS** 352 Japanese Linguistics: Analyzing the Grammar of Japanese
- JAS** 370 Contemporary Japanese Visual Culture: Anime
- JAS** 375 Japanese Cinema II: The History Film
- JAS** 380 Akita Studies II: Rural Culture and Society

## Japanese Language

### Pre-Elementary Course

- JPL** 100 A Basic Introduction to Communicating in Japanese

### Core Courses

- JPL** 110 Elementary Japanese
- JPL** 210 Upper Elementary Japanese I
- JPL** 220 Upper Elementary Japanese II
- JPL** 310 Intermediate Japanese I
- JPL** 320 Intermediate Japanese II
- JPL** 330 Intermediate Japanese III
- JPL** 340 Intermediate Japanese IV
- JPL** 410 Higher Intermediate Japanese I
- JPL** 420 Higher Intermediate Japanese II
- JPL** 460 Advanced Japanese I
- JPL** 470 Advanced Japanese II

### Skill Courses

- JPL** 213/413/423 Speaking
- JPL** 214 Kanji for Beginners
- JPL** 311/321/331 Reading Comprehension
- JPL** 314 Kanji Foundation
- JPL** 315/415 Pronunciation
- JPL** 324 Kanji Consolidation
- JPL** 412 Writing
- JPL** 431 Reading Current Topics
- JPL** 433 Japanese Language in Films
- JPL** 461 Reading Authentic Materials

### Translation/Interpretation

- JPL** 417 Japanese-Chinese Translation
- JPL** 427 Chinese-Japanese Interpretation

### Japanese Language Teaching

- \*Native fluency of Japanese is required.
- JLT** 181 Introduction to Japanese Language Studies
- JLT** 211 Japanese Phonetics
- JLT** 231 Teaching Japanese as a Second Language

### Other Languages - Chinese, French, Korean, Russian and Spanish

- 100/200/300 Levels I/II/III
- 400 Language Seminar: Discourse Practice (Chinese and Korean only)

## Business & Economics

- ECN** 205 Mathematical Methods for Economics
- ECN** 220 Analysis of Economic Data
- ECN** 230 International Financial Management
- ECN** 250 Foundations of Managerial Decision-Making
- ECN** 270 Principles of Marketing
- ECN** 300 Management Principles and Practices
- ECN** 301 Financial Theories and Applications
- ECN** 308 Marketing Channel Strategy

- ECN** 309 International Business Law
- ECN** 312 Financial Accounting
- ECN** 314 Managerial Accounting
- ECN** 315 Japanese Finance and Practices under Globalization 
- ECN** 316 Quantitative Methods for Marketing
- ECN** 317 Consumer Behavior
- ECN** 318 Global Marketing
- ECN** 320 International Trade
- ECN** 323 Money, Banking and Financial Markets
- ECN** 325 Economic Development
- ECN** 327 Econometrics and Applications
- ECN** 328 Intermediate Microeconomics
- ECN** 330 Corporate Finance
- ECN** 334 Strategic Management
- ECN** 337 Technology and Society
- ECN** 341 Human Resources Management
- ECN** 343 Japanese Business Culture 
- ECN** 344 Eco-Business and Sustainability
- ECN** 347 Portfolio Management
- ECN** 348 Behavioral Finance
- ECN** 353 MBA Essentials
- ECN** 354 Social Entrepreneurship
- ECN** 365 EU Politics and Economy
- ECN** 366 Intermediate Macroeconomics
- ECN** 367 Open-Economy Macroeconomics
- ECN** 368 Environmental Economics
- ECN** 391 Digital Marketing Strategy
- ECN** 392 Marketing Communication

## History

- HIS** 210 U.S. History
- HUM** 290 History of Modern China
- HIS** 296 History of Modern Korea
- HIS** 297 History of Modern Mongolia

## Political Science & International Relations

- PLS** 210 International Relations
- PLS** 220 Introduction to Political Thought
- PLS** 245 International Law and Institutions
- PLS** 250 Nations and Nationalism
- PLS** 260 Comparative Politics
- SOC** 280 International Cooperation and Development I
- SOC** 335 International Cooperation and Development II
- PLS** 340 Japan-U.S. Relations 
- PLS** 360 Modern Chinese Politics and Thought
- PLS** 361 Foreign Policy of China
- PLS** 362 Japan-China Relations 
- PLS** 363 Developmental Politics in South Korea
- PLS** 367 Politics and Society in Southeast Asia
- PLS** 376 Law and Politics of International Organizations

- PLS** 378 International Security
- PLS** 380 Borders and Migration
- PLS** 381 Forced Migration
- PLS** 386 Political Communication
- PLS** 387 Visual Politics
- PLS** 390 U.S. Foreign Relations

## Sociology

- SOC** 200 Research Methods in the Social Sciences
- SOC** 285 Community Development
- SOC** 325 Rural Sociology
- SOC** 326 Urban-Rural Linkages and Community Development
- SOC** 370 Mass Media and Society
- SOC** 375 Taiwan Society Today
- SOC** 385 Russian Society Today

## Environmental & Sustainability Studies

- SUS** 205 Sustainability Education
- SUS** 310 Conservation and Sustainable Development
- ENV** 320 Environmental Science in Global Perspective

## Geography

- GEO** 260 Urban Geography
- GEO** 270 Rural Geography
- GEO** 300 Diversity Matters

## Digital & Technology

- DGT** 200 Learning and Technology
- MAT** 230 AI, Games and Mathematics: Igo Math
- MAT** 240 Mathematics for the Digital World
- MAT** 300 Data Modeling: Visualization and Causal Inference
- PSY** 310 Cyberpsychology
- CCS** 320 Machine Learning and Big Data
- DGT** 320 Digital Meaning Making
- DGT** 330 Artificial Intelligence and Humanity
- DGT** 340 Digital Communities around the World
- MAT** 340 Poetry of Programming

## Media & Communication

- COM** 260 News Media, Culture and Ideology
- COM** 280 Science Communication
- CCS** 290 Cross-Cultural Collaboration Projects
- SOC** 290 Media Literacy
- COM** 360 Applied Pragmatics
- SOC** 371 Global Media



Open 24/7 All Year Round

# Nakajima Library and IT Labs



Nakajima Library is the place where you can access the study materials you need anytime around the clock. We have strong linguistics and social science collections, including subjects such as Japanese language, history, and culture. In addition to the bilingual online library catalog, our reference service is available in English to support your study needs.

Books: 80,000+ titles (50,000+ titles in English)

Journals: 200+ titles (100+ titles in English)

e-Books: 430,000+ titles

e-Journals: 1,500+ titles

Digital Resources: JSTOR, ProQuest Central, ScienceDirect, EBSCOhost eBook Collection, Ebook Central, etc.

## Award-Winning Design

The library is a tourist destination and cultural icon, and receives many visitors throughout the year in addition to library users.

Built from local Akita cedar, with the ceiling patterned on a traditional umbrella, the library offers a warm, sheltering atmosphere, study rooms with individual workplaces, tables, and study rooms providing a variety of ideal study environments.

## Hybrid Library



Nakajima Library collects both printed and digital materials for your study and research needs. Access over 430,000 e-books and more than 1,500 e-journals from anywhere.

Our discovery service, "ONE-Search" will allow you to search both printed materials and digital resources at once, along with other open access materials online.

## 24-Hour Computer Labs



Inside the library building, we have computer labs with over 100 computers (Windows OS in English or Japanese), printers and scanners available. Students who prefer to use personal computers and other devices, are able to use free Wi-Fi on campus.

**Most Beautiful Library  
in Eastern Japan**

Nikkei, September 2015

**Top 10 Must-See University  
Landmark**

Nikkei, October 2016



# Campus Life and Academic Support

## Student-Centered Learning Space

From active learning facilities to guaranteed housing, meal plans, and on-campus medical support, AIU has your study abroad needs covered.



## LANGUAGE DEVELOPMENT AND INTERCULTURAL STUDIES CENTER (LDIC)

### Learning Resources for Multiple Languages

Improve your Japanese or work on a third or fourth language! The LDIC offers language resources for various learning styles.

### Open Class

The Open Class is a chance for members of the AIU community to get a glimpse of a new language, topic, or lecture.

### Rated-Ex (for experience)

This is an opportunity for members of the AIU student body, staff, or faculty to showcase talents and skills to the AIU community.

### Infinity Room

The Infinity Room is both a physical (a self-access center) and a virtual space (online meetings) designed for experiencing Mathematics in a positive and enjoyable way. Emphasizing the playful, the aesthetic and the mind-blowing aspects, the room is a gateway into collaborative mathematical research with paths leading to other STEM subjects and to a well-rounded liberal art worldview.

## ACADEMIC ACHIEVEMENT CENTER (AAC)

### Free Peer Tutorial Support

Academic Reading/Writing/Presentation skills, Japanese language, and content course support.

### Foreign Language Conversation Partner (FLCP) program

Through this program, you can meet one-on-one with speakers of other languages. Whether you want to practice a new language or help other students practice your language, it is a great opportunity to make new friends and develop your skills in a relaxed environment.



#### STUDENT VOICE

### Victor Baltazar Luna

The University of Colima, Mexico

The FLCP program was an excellent opportunity to share both my native language and my country. It was absolutely amazing to see how many students are interested in learning Spanish and other languages. Also, it was very fulfilling to see how the students became more fluent with each session. It was also interesting that at the same time they are learning new vocabulary they are learning about a country from a first-hand source. The FLCP program is an amazing experience to get to know other countries and cultures more deeply. It is a great way to prepare yourself if you're looking to go abroad in the future. I highly encourage everyone to be part of the FLCP program!





# Housing and Dining



## 100% GUARANTEED ON-CAMPUS HOUSING FOR INTERNATIONAL STUDENTS

More international and Japanese students cite living in the on-campus community as their favorite part of studying at AIU over all other aspects of life and study. When you live in Komachi Hall, Global Village, Sakura Village, or our Themed Houses in Tsubaki Village, you are never more than a 10-minute walk from your friends, classes, and our wealth of on-campus activities.

### Housing Options

		Komachi Hall	Global Village	Sakura Village	Tsubaki Village (Themed House)
Room Style		Double occupancy room; two-room suite	Double occupancy	Single bedroom; triple occupancy suite	Single bedroom; twelve occupancy suite
Number of rooms (wheelchair accessible)		244(4)	196(4)	107(2)	255(3)
Toilet, Bath/Shower		Separate; Two per suite. Shower only.	One unit bath per room	Separate; One per suite	Separate; Four per suite
Kitchen		Community kitchen/ dining room for all residents	Induction cooktop in room	Induction cooktop in suite	Induction cooktop in suite
Fees	Fall/Spring Per Semester	130,000 JPY (Fall) 126,000 JPY (Spring)	143,500 JPY (Fall) 139,500 JPY (Spring)	220,000 JPY (Fall) 216,000 JPY (Spring)	220,000 JPY (Fall) 216,000 JPY (Spring)
	Winter Semester	88,000 JPY	97,000 JPY	148,000 JPY	148,000 JPY
	Utilities	Utilities Included			

\* Fees are subject to change.

### Komachi Hall

All AIU degree-seeking students are required to live in Komachi Hall for their first year, so this is a great place to live if you want to make friends with Japanese students. Floor-by-floor activities, a common kitchen, and lounge with satellite TV and games make Komachi a natural choice for students who want more social interaction.



Komachi Hall

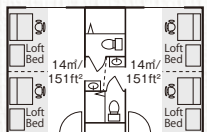

### Campus Apartments

Global Village, Sakura Village, Tsubaki Village

The campus apartments offer a little more privacy as well as the opportunity for students to cook for themselves. Global Village has a double-occupancy bedroom connected to a kitchenette area. Sakura Village offers three separate bedrooms connected to a common Kitchen/Dining/Living area. Tsubaki Village, the newest housing facility, which hosts the Themed Houses, also has a shared Kitchen/Dining/Living area.



Global Village



Sakura Village

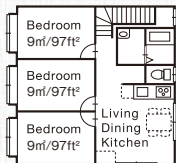

Tsubaki Village

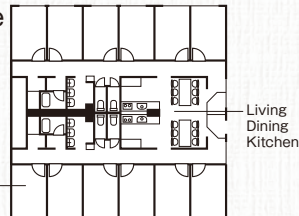

### Dining Options



#### Cafeteria

With floor-to-ceiling windows, a piano, and TVs to catch up on international news, the cafeteria offers meal plans and a la carte options. Students with special dietary needs, from allergies to halal or vegan diets, can arrange for meals to meet their needs as well.



#### College Café

For a coffee shop or café environment, with a permanent menu and weekly specials, take a seat in College Café, inside or out. College Café also hosts club concerts and serves alcohol to students of age in the evenings.



# Themed Houses



## THEMED ACTIVITY-BASED HOUSING OPTION

Themed Houses at AIU offer international and Japanese students the opportunity to live together based on common interests and work together on projects and activities throughout the semester. Themed Houses began with the Japan House (Japanese Arts and Culture House) in the Spring 2015 and the number of houses and their specific themes change each semester. Themes from the Spring 2023 Semester can be found below.

### Themed Houses as of Spring 2023

- Nihongo House
- Russian (Slavic) Language & Culture House
- Migration House
- Well-being House



#### STUDENT VOICE

### Flora Cecilia Alaksza

University of Exeter, UK

This fall semester I participated in the “Migration House”, which was a great opportunity to learn more about migration and related social and political issues, as well as to meet new people and have discussions in a relaxed environment. I enjoyed the wide range of activities organized by this Themed House, such as discussion groups where we shared our own research, watching documentaries, and speaker events. As an international exchange student, it was particularly interesting for me to look at certain topics from the perspective of Japanese students, and to learn about Japan’s migration policies.

## ON-CAMPUS MEDICAL SUPPORT

AIU takes international students’ health seriously. From pre-arrival consultation on students’ existing conditions, allergies, and care, to first aid and medical follow-up during your study abroad, our medical staff is committed to ensuring that you remain healthy and comfortable throughout your stay. AIU became a smoke-free campus in April 2019.

### Medical Services

All Free of Charge

- Pre-arrival medical consultation and care planning
- On-campus medical center and nurse for general first aid
- Local clinic / hospital referrals for examinations / prescriptions
- Advice and examples of Japanese / international medicinal equivalents
- Adaptable to international practices
- AEDs and First Aid kits available around campus
- Health maintenance and training events throughout the year

With regular hours and after-hours emergency contact information, international students can be sure that an English speaker will be close by in the event of any emergencies.

### Health and Fitness Events

Students who take advantage of AIU’s local community interaction, on-campus festivals, and club activities may find their study abroad experience to be more active than their average semester at home. AIU takes a proactive approach to medicine to help students remain in top condition, with health classes, fitness events, first aid/CPR training workshops, and flu shots available on campus.

## COUNSELING ROOM

AIU’s counseling staff has years of experience in helping English- and Japanese-speaking students through culture shock and adjustment to life in Japan. Although AIU offers a small campus environment with a close community and an emphasis on interaction, we understand that studying abroad can be a challenging adjustment.

### Free Support

As with medical support, our counseling staff reviews students’ needs prior to arrival to begin consultation and care planning, based on students’ medical information form entries. During your stay at AIU, you can make an appointment by email or in person to discuss any of the stresses related to your study abroad or daily life. Our staff has particular expertise in intercultural adjustment and culture shock and can help with a wide range of issues including interpersonal relationships and time management. Of course, all counseling discussions are strictly confidential to protect students’ privacy.

## EXERCISE ROOM



Keep up your fitness habit or start a new one in Suda Hall’s training room or on its indoor running track. The main hall also converts to an indoor court for team sports.



# Semester/Year Program

## APPLICATION INSTRUCTIONS

Spend a semester or a year at AIU! We welcome new short-term international students from our 203 exchange partners in 51 countries during the fall and spring semesters. No Japanese language proficiency required.

### Eligibility

- GPA: 2.50 (on a 4.00 scale)
- English Language Proficiency: TOEFL iBT® TEST 71 or equivalent.
- Completed at least 2 semesters prior to beginning your application.
- Be enrolled at your home university throughout your application and study abroad period.

### Academic Calendar

	Fall Semester	Winter Program	Spring Semester
Orientation*	Late August	n/a	Early April
Classes Begin	Early September	Early January	Early April
Classes End	Late December	Early March	Late July

\*Orientation is mandatory for all students.  
The above schedule is subject to change. Please refer to our website (<https://web.aiu.ac.jp/en/academic/academic-calendar/>) for the most up-to-date information.

### Fall and Spring Semesters

Start your studies at AIU in either the Spring or Fall Semester. Students are required by law to register for at least 12 credits, and they may take up to a maximum of 18 credits per semester.

### Winter Program

Take extra credits for zero tuition during our Winter Program! This intensive, 7.5-week extension program is only available to students enrolled in the Fall semester. In winter, a variety of intensive Japanese language courses are offered so this is a great period for Japanese learners to improve Japanese language skills while at AIU.

### Application Timeline

Application Period	Fall	Spring
Online Nomination Deadline	February 20	September 20
Online Application Opens	February 1	September 1
Application Documents Deadline	April 1	November 1
Acceptance Letter Issued	April 30	November 30

Your Inbound Exchange Coordinator at AIU will support and guide you through the visa application process, housing application, and all other required steps. You can find additional details at: <http://web.aiu.ac.jp/en/short-term/semester-year-programs/application-timeline/>.

### Tuition and Fees

	Fall / Spring Semester		Winter Program
	Exchange Partners	Fee-Paying	All Students
Admission Fee	Waived	28,200 JPY	n/a
Tuition	Waived	348,000 JPY	Waived
Housing	126,000 – 220,000 JPY		88,000 – 148,000 JPY
Bedding/Cleaning	23,000 JPY		7,200 JPY
Mandatory Meal Plan* (first two weeks)	17,800 JPY		n/a
Semester Meal Plan (optional)	91,300 JPY (15 meal plan), 68,100 JPY (10 meal plan), 40,200 JPY (Saturday, Sunday, and Holiday meal plan)		Approx. 39,000 JPY
Student Activity**	20,000 JPY		9,000 JPY
Deposit***	20,000 JPY (first semester only)		n/a
Total (Maximum)	432,300 JPY	808,500 JPY	203,200 JPY

\*All students need to purchase a Mandatory Meal Plan for the first two weeks. After that, you may buy 15 meal plan (91,300 JPY), 10 meal plan (68,100 JPY), and a Weekend and Holiday meal plan (40,200 JPY). A la carte purchase and pre-paid cards are also available. \*\*The Student Activity fee includes mandatory insurance (including Japanese National Health Insurance and Student Liability Insurance). \*\*\*Any remaining deposit will be refunded to students at the time of departure. Fees are subject to change.

## Degree Program

### Four-Year Bachelor's Degree Program

While the majority of international students at AIU come from one of our partner universities for a semester or year of exchange, we admit international degree-seeking students, as well. Four-year international students at AIU follow the same requirements and course structure as Japanese students, including an all-English curriculum and required year of study abroad outside Japan.

### 4-Year Course Structure

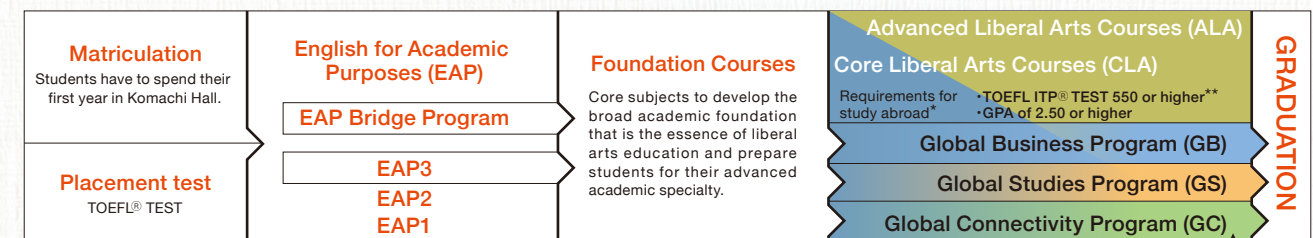

\*All students are required to study abroad one year  
\*\*TOEFL, TOEFL iBT, TOEFL ITP and TOEIC are registered trademarks of Educational Testing Service (ETS).  
This brochure is not endorsed or approved by ETS.

\*124 CREDITS \*\*GPA of 2.00 or Higher

# Akita

Where Traditional and Modern Japan Coexist  
**Overview**

Akita City is located on the west coast of Japan's Tohoku region, the northern stretches of the main island, Honshu. A small city of approximately 300,000 residents, it is known for its stunning natural environment, wide variety of folk culture and performances, and its warm, welcoming people.

### Basic Information / AKITA Prefecture

**927,561** Population  
» As of December 2022

**3,620** International Residents  
» As of December 2021

**11,637.52** km<sup>2</sup>  
(slightly smaller than the US state of Connecticut)

**11** Colleges and University  
» As of January 2022

**1** hour by air from Tokyo

## Akita Highlights

### 田舎と都会 Town and Country

In Akita, you are never far from wooded hills or lush fields, but there are pockets of urban convenience close at hand, as well, including shopping centers and a wide selection of restaurants around Akita Station.

### 秋田弁「んだ」 Akita-Dialect

The language you hear around Akita, especially in rural areas, can sound foreign even to native Japanese. You'll come away with unique vocabulary to prove you didn't study only from a textbook.

### 祭 Festivals

Akita is home to more designated Important Intangible Folk Cultural Properties than any other prefecture, such as the Namahage gods of Oga Peninsula and the haunting Nishimonai Bon-Odori dance, as well as large annual festivals like Kanto Matsuri and the Omagari Fireworks Festival that draw hundreds of thousands of visitors from Japan and around the world.

Experience The Real Japan  
Access To Authentic, Rural Japanese Culture





# Worldwide Network

203 Exchange Partners in 51 Countries and Regions »As of March 31, 2023

## AFRICA 4

 <b>EGYPT</b>	Egypt - Japan University of Science and Technology Cairo University The American University in Cairo
 <b>MOROCCO</b>	Al Akhawayn University

## ASIA 42

 <b>BRUNEI</b>	Universiti Brunei Darussalam
 <b>CHINA</b>	Jilin University Nanjing University Nankai University Wuhan University
 <b>HONG KONG</b>	The Chinese University of Hong Kong Hong Kong Baptist University Lingnan University The University of Hong Kong
 <b>INDONESIA</b>	Universitas Indonesia
 <b>KOREA</b>	Ajou University Busan University of Foreign Studies Ewha Womans University Konkuk University Korea Advanced Institute of Science and Technology Korea University Seoul National University Sogang University Yonsei University
 <b>MACAU</b>	Macau University of Science and Technology University of Macau
 <b>MALAYSIA</b>	Universiti Sains Malaysia University of Malaya
 <b>MONGOLIA</b>	National University of Mongolia University of the Humanities
 <b>PHILIPPINES</b>	Ateneo de Manila University
 <b>SINGAPORE</b>	Nanyang Technological University National University of Singapore
 <b>TAIWAN</b>	Fu Jen Catholic University Kainan University National Chengchi University National Chi Nan University National Taiwan Normal University National Taiwan University Tamkang University Yuan Ze University

 <b>THAILAND</b>	Chulalongkorn University Kasetsart University Mahidol University Thammasat University
 <b>VIETNAM</b>	Foreign Trade University VNU University of Economics and Business

## EUROPE 74

 <b>AUSTRIA</b>	FH Joanneum University of Applied Sciences
 <b>BELGIUM</b>	Ghent University Vesalius College
 <b>CROATIA</b>	Zagreb School of Economics and Management
 <b>CYPRUS</b>	University of Nicosia
 <b>CZECH REPUBLIC</b>	Masaryk University
 <b>DENMARK</b>	Aalborg University Aarhus University
 <b>ESTONIA</b>	Tallinn University
 <b>FINLAND</b>	Tampere University University of Lapland University of Vaasa
 <b>FRANCE</b>	Burgundy School of Business ESC Rennes School of Business NEOMA Business School Rennes 2 University Sciences Po Grenoble Sciences Po Lille Sciences Po Rennes Toulouse Business School Université Toulouse - Jean Jaurès Ludwigshafen University of Business and Society Philipps-Universität Marburg University of Passau
 <b>GERMANY</b>	
 <b>HUNGARY</b>	University of Pécs
 <b>IRELAND</b>	Maynooth University
 <b>ITALY</b>	University of Bologna University of Ferrara University of Siena University of Turin Ca' Foscari University of Venice
 <b>LATVIA</b>	University of Latvia
 <b>LITHUANIA</b>	Vilnius University Vytautas Magnus University

 <b>MALTA</b>	University of Malta
 <b>NETHERLANDS</b>	Amsterdam University of Applied Sciences HAN University of Applied Sciences Hanze University of Applied Sciences, Groningen Leiden University
 <b>NORWAY</b>	NHH Norwegian School of Economics University of Bergen University of Oslo
 <b>POLAND</b>	University of Lodz Warsaw School of Economics
 <b>PORTUGAL</b>	ISCTE-Lisbon University Institute Universidade Catolica Portuguesa University of Porto
 <b>ROMANIA</b>	University of Bucharest
 <b>RUSSIA</b>	Far Eastern Federal University International University in Moscow Lomonosov Moscow State University National Research University Higher School of Economics
 <b>SLOVAKIA</b>	Comenius University
 <b>SLOVENIA</b>	University of Ljubljana
 <b>SPAIN</b>	Universidad de Alicante Universitat Autònoma de Barcelona Universidad de Burgos Universidad Carlos III De Madrid Universidad de Jaén Universidad de Málaga
 <b>SWEDEN</b>	Linköping University Linnaeus University
 <b>SWITZERLAND</b>	Eastern Switzerland University of Applied Sciences Zurich University of Applied Sciences Winterthur
 <b>UK</b>	Keele University Newcastle University The University of Sheffield University of Aberdeen University of Central Lancashire University of East Anglia University of Essex University of Exeter University of Leeds University of Sussex

## NORTH AMERICA 67

 <b>BAHAMAS</b>	University of the Bahamas
 <b>CANADA</b>	Université Laval University of Manitoba University of Toronto University of Victoria University of Waterloo University of Windsor Wilfrid Laurier University

 <b>MEXICO</b>	The University of Colima
 <b>USA</b>	Alverno College Arizona State University Ball State University Beloit College Centre College The College of William and Mary Dickinson College Drexel University Eastern Oregon University George Mason University The George Washington University Gonzaga University Hamline University Hampden-Sydney College High Point University Ithaca College Knox College Lincoln Memorial University Lyon College Marist College Millsaps College Mississippi State University Monmouth College Oregon Institute of Technology Oregon State University Portland State University Presbyterian College San Diego State University San Francisco State University
	Southern Oregon University St. Cloud State University St. Mary's College of California St. Mary's College of Maryland State University of New York at Oswego Towson University Union College University of California, Berkeley University of California, Davis University of Colorado, Boulder University of Delaware University of Denver The University of Hawai'i, Manoa University of Illinois at Urbana-Champaign The University of Kentucky University of Maine at Farmington University of Mary Washington University of Mount Union The University of New Mexico University of Northern Iowa University of Oregon University of Richmond University of South Florida University of Utah Ursinus College Washington & Jefferson College Western Oregon University Western Washington University Winona State University

## OCEANIA 13

 <b>AUSTRALIA</b>	The Australian National University Deakin University Griffith University La Trobe University Macquarie University Swinburne University of Technology The University of New South Wales University of Southern Queensland The University of Sydney The University of the Sunshine Coast The University of Western Australia
 <b>NEW ZEALAND</b>	University of Canterbury Victoria University of Wellington

## SOUTH AMERICA 3

 <b>CHILE</b>	Universidad Adolfo Ibáñez
 <b>PERU</b>	Universidad del Pacifico Universidad San Ignacio De Loyola

\*List includes partnerships with specific faculties or colleges at partner universities.